

RAUMPLAN VILLA RISSEN HAMBURG



VILLA RISSEN
HAMBURG





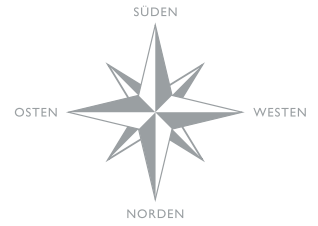

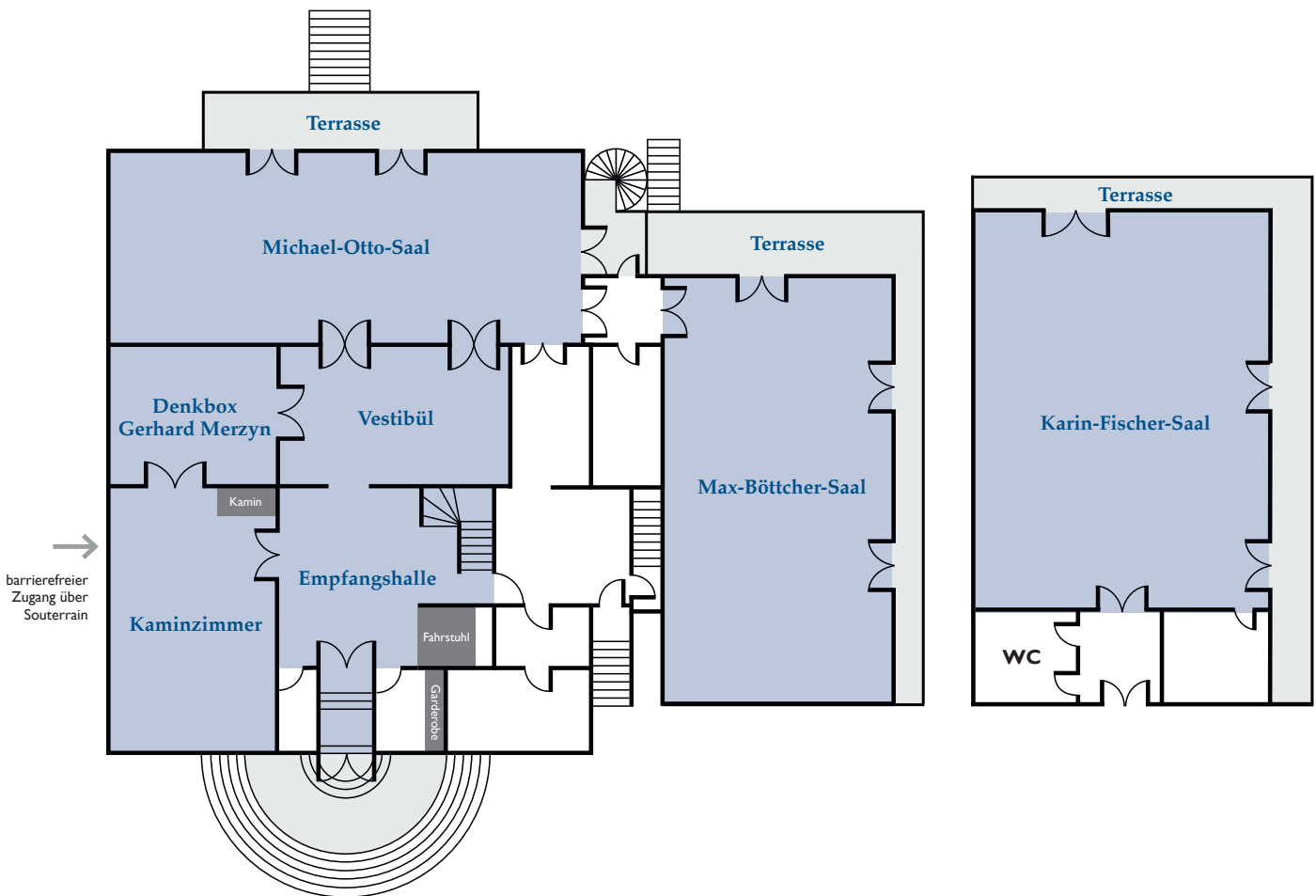

Raumplan



Erdgeschoss / Gartengeschoß



Größe Höhe Bestuhlung

									
			Parlamentarisch	Block	U-Form	Stuhlkreis	Empfang	Bankett	Theater
Empfangshalle	33 qm	2,80 m	-	-	-	-	20	-	-
Vestibül	33 qm	2,80 m	-	-	-	-	20	16	-
Denkbox GM	29 qm	2,80 m	12	16	-	20	20	16	24
Kaminzimmer	55 qm	2,80 m	20	20	20	26	40	24	50
Max-Böttcher-Saal	99 qm	2,80 m	40	32	24	40	150	64	120
Karin-Fischer-Saal	122 qm	3,20 m	46	50	30	50	200	80-100	180
Michael-Otto-Saal	120 qm	2,60 m	46	50	30	50	200	80-100	180



Raumplan

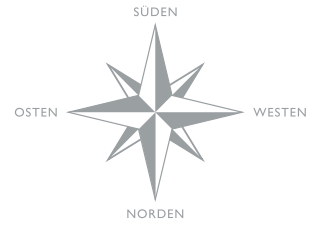





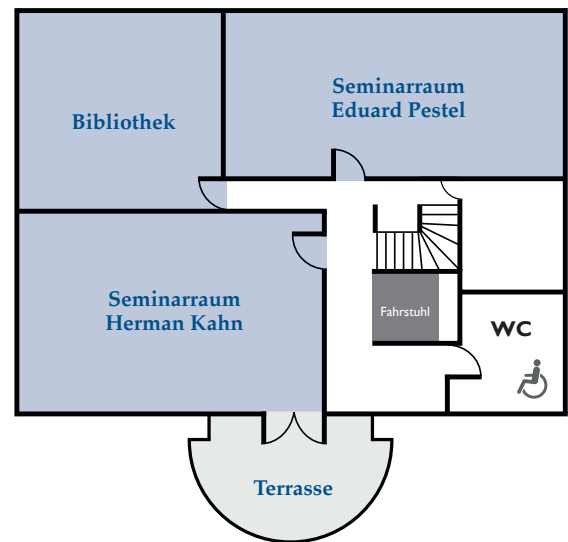
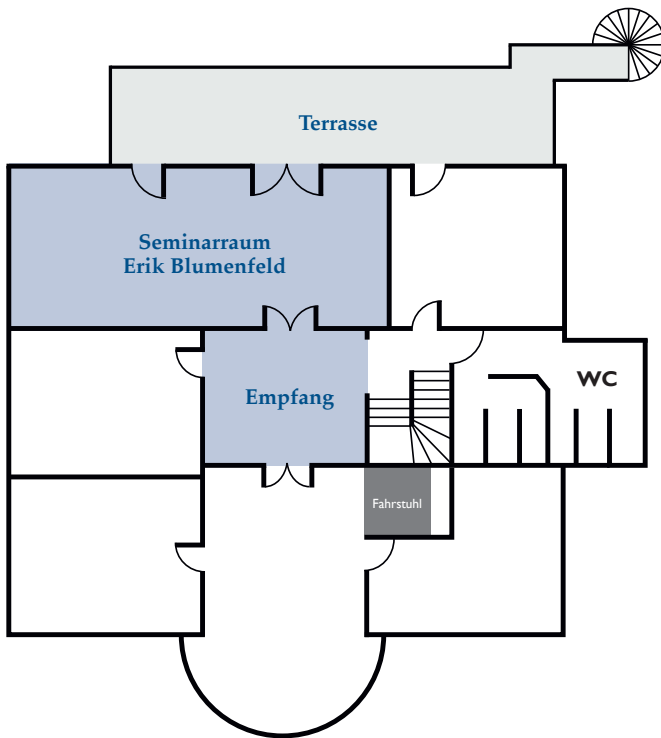

Obergeschoss

Dachgeschoss



Größe Höhe Bestuhlung

								
			Parlamentarisch	Block	U-Form	Stuhlkreis	Bankett	Theater
Konferenzraum Erik Blumenfeld	53 qm	3,00 m	20	18	23	20	18	40
Seminarraum Eduard Pestel	40 qm	3,50 m	16	24	16	22	-	-
Bibliothek	27 qm	3,50 m	-	8	-	8	-	-
Seminarraum Herman Kahn	54 qm	3,50 m	24	20	22	22	-	50



VILLA RISSEN
HAMBURG